



VICKI LANE

### TENANT INFORMATION

NO.	TENANT	SQ. FT.
	THE STABLES EVENT CENTER	9,356
100	MAINELLI WAGNER & ASSOCIATES	1,977
102 & 103	AVAILABLE	2,332
104	DR. NICHOLS KUCHAR	918
105 & 106	WOMEN'S LIFELINE CENTER	1,500
107	WOMEN'S LIFELINE CENTER	1,288
108	J HANSEN WEALTH STRATEGIES	972
109	AVAILABLE	972
110	AVAILABLE	2,021
<b>TOTAL (SQUARE FEET)</b>		<b>21,336</b>



S 20TH ST

SIGNAGE

THE STABLES EVENT CENTER  
9,356 SF

40' 40' 18' 44' 23' 18' 23' 35'

100 1,977 SF

102 & 103 2,332 SF

104 918 SF

105 & 106 1,500 SF

107 1,288 SF

108 972 SF

109 972 SF

110 2,021 SF

### TIME SQUARE

NORFOLK, NEBRASKA

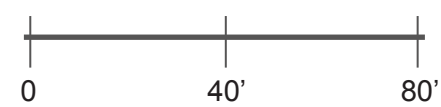

402.496.3300 | wchapman@perkinsproperties.us



PERKINS PROPERTIES

INVESTMENT REAL ESTATE  
SALES AND DEVELOPMENT

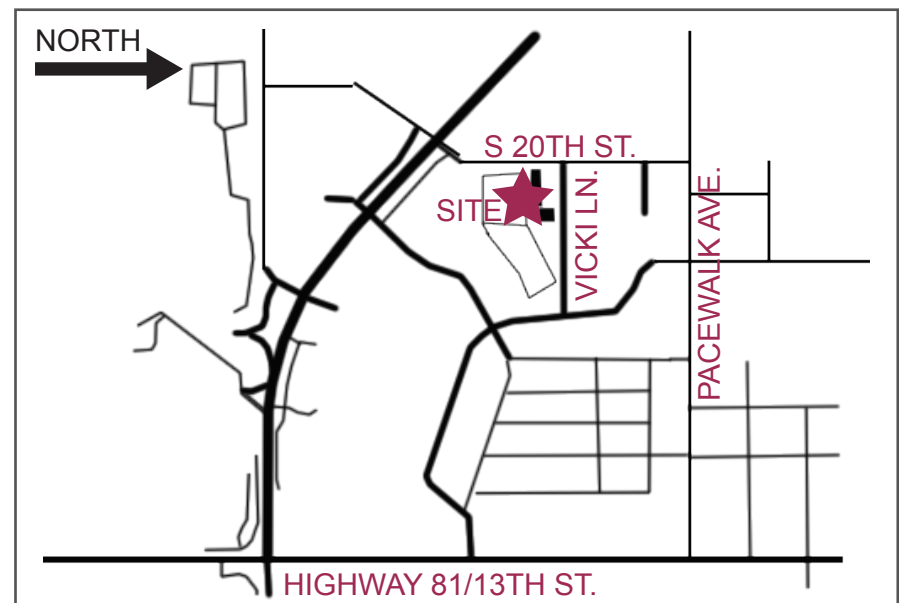

VICINITY MAP

NOT TO SCALE